



# Luvanto

## Luxury Design Flooring

## Luvanto Endure Pro

### TECHNICAL INFORMATION

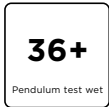
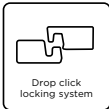

Characteristics	Test Method	Result
Level of Use	EN685	Domestic 23, Commercial 34
Total Thickness	EN428	6mm (inc. 1mm IXPE acoustic underlay)
Wear Layer	EN429	0.7mm
Total Weight	EN430	8600g/m <sup>2</sup>
Dimensions (Planks)	EN427	180mm x 1220mm
Dimensions (Tiles)	EN427	300mm x 600mm
Surface Treatment		PU
Warranty		Lifetime Domestic / 20 Years Commercial
Flammability	EN13501-1:2007 +A1:2009	Bfl-S1
Water Resistance		100%
Dimensional Stability	EN ISO 23999	≤0.15%
Formaldehyde Emission	EN14041:2004	Class E1
VOC Emission		A+
Slip Resistance	DIN 51130	R10
Pendulum Test	BS7976-2:2002	Dry 62 (Low) Wet 38 (Low)
Stain Resistance	EN423	Pass
Residual Indentation	EN433	<0.1mm
Castor Chair Resistance	ISO 4918	25000 Cycles Pass
Colour Fastness to Light	ISO 105 B02	>6
Click Tension	Internal	300N/50mm
Sound Reduction	ISO 140-8/ ISO717-2	22dB
Underfloor Heating		Suitable, Max 29°C Surface Temperature